

HSF

NOTES:

Rated Current: 3.0AMP.(20°C, 1*2P-1*15P)
 2.0AMP.(20°C, 1*16P-1*40P) $\triangle A2$
 Contact Resistance: 20m Ω Max.
 Withstand Voltage: 500V AC/DC
 Insulation Resistance: 1000M Ω Min.
 Operation Temperature: -40°C to +125°C (Gold Plating) $\triangle A2$
 -40°C to +105°C (Tin Plating) $\triangle A2$
 Contact Material: Copper Alloy
 Contact Plating: Au or Sn Over 30u" Min Ni $\triangle A1$
 Insulator Material: PA9T+G.F UL94V-0 BK $\triangle A2$

Recommended P.C.B Layout (Top Side)
 (PCB BOARD TOLERANCE ± 0.05)
 (PCB Thickness: T=1.60m)

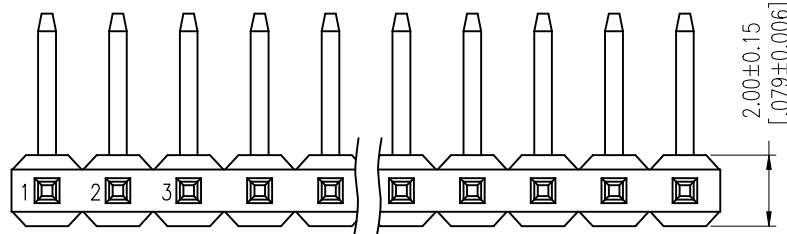
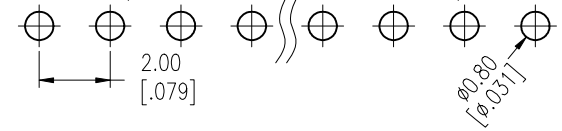

Ordering Information

1220- 1 1 XX XX R XXX C 0 XX $\triangle A1$

Plastic Layer
 Plastic Row
 No. of Pins
 Per Row: 02-40
 Contact Plating
 G0=Gold Flash
 G3=10u"Au, BG3=8u"PdNi+2u"Au
 G4=15u"Au, BG4=13u"PdNi+2u"Au
 G5=30u"Au, BG5=28u"PdNi+2u"Au
 S0=Gold Flash/Tin
 S3=10u"Au/Sn, P3=8u"PdNi+2u"Au/Sn
 S4=15u"Au/Sn, P4=13u"PdNi+2u"Au/Sn
 S5=30u"Au/Sn, P5=28u"PdNi+2u"Au/Sn
 SN=Bright Tin $\triangle A2$
 SM=Matte Tin

Series No. 01-99
 Packing 0=PE Bag
 Insulator Material C=PA9T
 Pin Length L (See Table)
 Type: R:R/A

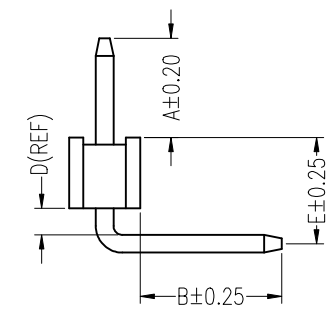
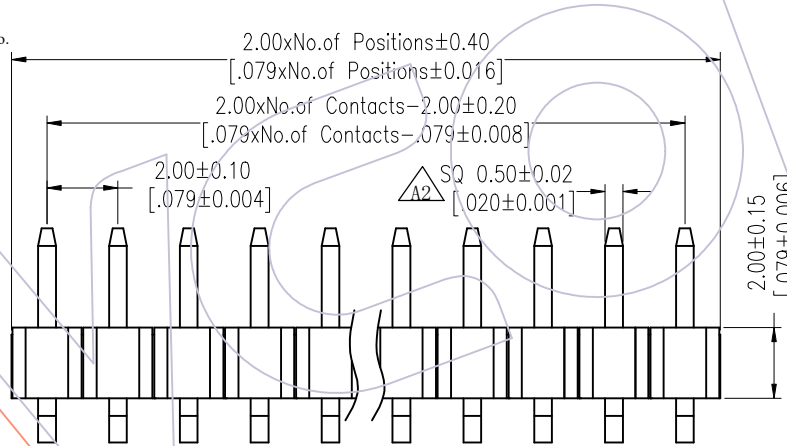

Item	Pin Length	A	D	E	B	Mating
Standard	9.0	2.80	0.75	3.0	2.5	2220T/2221/2228
	9.5				3.0	2227T/2228T/2245
	10.0				3.5	2235/2240N/2243C
	10.5				4.0	2240/2243/2245T/2263/2272
Standard	8.0	2.0 (THR)	0.75	3.0	2.5	2220T/2221/2228
	8.5				3.0	2227T/2228T/2245
	9.0				3.5	2235/2240N/2243C
	9.5				4.0	2240/2243/2245T/2263/2272
Alternate						

REV	DATE	MODIFICATION DESCRIPTION	CHANGE	OPERATION	DRAW	DATE	SCALE	Fit	PART NO.
A2	2025/08/04	Standardization Drawing	CP	x.X ±0.40	CP	2025/08/04	UNIT	mm	1220-11XXXXRXXXC0XX $\triangle A1$
A1	2018/01/18	Modify P/N	Liu	x.XX ±0.25	CHECK	DATE	SIZE	A4	TITLE: PH2.00 SINGLE ROW 90° PLANE BENDING H=2.0
AO	2012/04/26	NEW	William Chen	x.XXX ±0.15	TANG	2025/08/04	SHEET	1/2	
				Angle ± 3'	APPROVE	DATE	PROJ.		Customer NO.
				DIM TOL	Steven Zhao	2025/08/04			

WCON
 Http: www.wcon.com

WCON-Dongguan Tel: +86 769 85358920 Fax: +86 769 85358915 E-mail: sales@wcon.com

WCON-Kunshan Tel: +86 512 57468408 Fax: +86 512 57468468 E-mail: salesks@wcon.com

HSF

Packing:

Packaging Quantity Refers To The Following Table

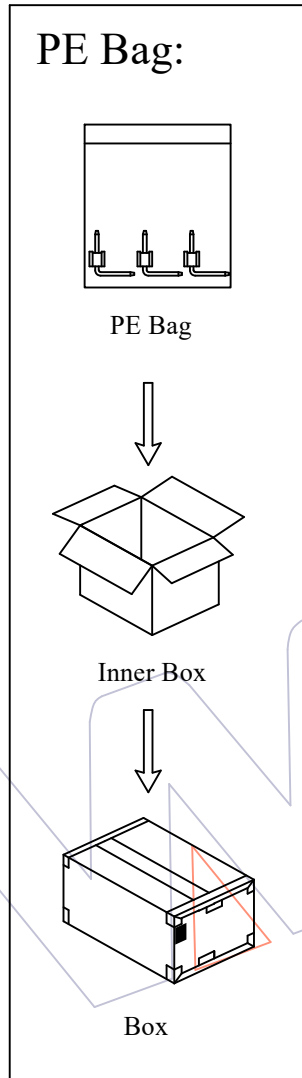

PINS	Q'ty/Bag (L ≤ 13.0)
1	1000
2	1000
3	1000
4	1000
5	1000
6	1000
7	1000
8	1000
9	1000
10	1000
11	1000
12	1000
13	500
14	500
15	500
16	500
17	500
18	500
19	500
20	500

PINS	Q'ty/Bag (L ≤ 13.0)
21	500
22	500
23	500
24	500
25	500
26	500
27	500
28	500
29	400
30	400
31	400
32	400
33	400
34	300
35	300
36	200
37	200
38	200
39	200
40	200

REV	DATE	MODIFICATION DESCRIPTION	CHANGE	OPERATION	DRAW	DATE	SCALE	Fit	PART NO.
A2	2025/08/04	Standardization Drawing	CP	x.X ±0.40	CP	2025/08/04	UNIT	mm	1220-11XXXXRXXXC0XX
A1	2018/01/18	Modify P/N	Liu	x.XX ±0.25	CHECK	DATE	SIZE	A4	TITLE:
AO	2012/04/26	NEW	William Chen	x.XXX ±0.15	TANG	2025/08/04	SHEET	2/2	PH2.00 SINGLE ROW 90° PLANE BENDING H=2.0
				Angle ± 3'	APPROVE	DATE	PROJ.		Customer NO.
				DIM TOL	Steven Zhao	2025/08/04			



Http: www.wcon.com

WCON-Dongguan Tel: +86 769 85358920 Fax: +86 769 85358915 E-mail: sales@wcon.com	WCON-Kunshan Tel: +86 512 57468408 Fax: +86 512 57468468 E-mail: salesks@wcon.com
---	--