

0.80mm (0.032")pitch,SMT Board-to-Board Connector
0.80毫米（0.032英寸）间距，表面贴装板对板连接器

Overview

3613 series is a 0.80mm pitch male-female integrated board-to-board connector. Combining high density, high performance and compact dimensions, it delivers stable signal transmission for equipment. Its unique dual-function design effectively reduces component count.

概述

3613系列是一款0.80mm间距公母同体板到板连接器；产品兼具高密度、高性能、体积小等特点，能为设备提供稳定的信号传输，其独特的公母二合一设计，有效减少元器件数。



Features and Benefits

- Integrated male-female assembly
- Metal components enhance reliability and improve mechanical strength
- Supports automatic placement, enhancing assembly efficiency
- Highly efficient and stable, with straightforward assembly

特点与优势

- 公母集成一体化
- 金属配件增强可靠性，提高机械性能
- 支持自动贴装，提高装配效率
- 高效稳定，装配便捷

Product Applications

- Industrial Control and Automation, Instrumentation
- Communications and Networking, Data Centres
- Medical equipment

应用领域

- 工业控制与自动化、仪器仪表
- 通信与网络、数据中心
- 医疗设备

Standard 标准

- EIA 364
- IEC 60512

UL certification UL认证

- E248993

Material 材料

Part/零件	Material/材料	Finish/电镀	UL Flame retardant/阻燃等级
Male/公座	LCP	Black/黑色	UL94V-0
Terminal/端子	Copper Alloy	Plated Au or SN over NI 镀金锡	-

Production Specifications 产品规格

Current rating 额定电流	0.5 A	Operating Temperature Range:-40° C~+105° (including temperature rise) Operating Humidity Range:20-80% 工作温度范围: -40° C~+105° C(含温升) 工作湿度范围: 20-80%	Storage Teroerature:25±5° C Humidity:≤60% 储存温度: 25±5° C 储存湿度: ≤60%
Voltage rating 额定电压	50V		

Item 项目	Condition 条件	Specification 规格
Insulation Resistance 绝缘电阻	Measured at 500V DC for 1 minute 测试电压: 500V DC/1分钟	No less than 1000M Ω 不少于1000MΩ
Withstanding voltage 耐电压	Measured at 250V AC for 1 minute 测试电压: 250V AC/1分钟	No breakdown, no discharge, leakage current <0.5mA 无击穿、无放电、漏电流<0.5 mA
Contact Resistance 接触电阻	Test Voltage 测试电压: 20mV Max Test current 测试电流: 100mA Max	Contact resistance: Initial value/ 65 mo max After environmental tests/ 75 mo max. 接触电阻: 初始值 65 mΩ 以下 测试后 75 mΩ 以下
Vibration Resistance 抗振动	Frequency: 50 ~ 2000 Hz PSD value: 5.35 G Duration: 15minutes/axis Vibration: X/Y/Z 频率: 20 ~ 2000 Hz PSD值: 5.35 G 时长: 15分钟/轴 方向: X/Y/Z	No electrical discontinuity of 1μsorgreater 试验过程中未发生1μs瞬断现象, 且外观无损伤, 电气性能正常
Humidity (Steady state) 湿度	Temperature: -25~+65° C Humidity: 90 ~95% (R.H) Duration: 96 hours 温度: -25~65° C 湿度: 90~95% (R.H) 时间: 96小时	Contact resistance: Initial value/ 65 mo max After environmental tests/ 75 mo max. 接触电阻: 初始值 65 mΩ 以下 测试后 75 mΩ 以下
Salt Spray 盐雾	Temperature 温度: 35±2°C Humidity 湿度: 95 ~ 98% (R.H) pH Value 酸碱值: 6.5~7.2 Duration 时间: 48H	Contact resistance: Initial value/ 65 mo max After environmental tests/ 75 mo max. 接触电阻: 初始值 65 mΩ 以下 测试后 75 mΩ 以下
Durability(Mating/un- mating) 插拔寿命	100 cycles 循环100次	Contact resistance: Initial value/ 65 mo max After environmental tests/ 75 mo max. 接触电阻: 初始值 65 mΩ 以下 测试后 75 mΩ 以下

PCB Layout 印刷电路板布局

Surface Mount Technology 表面贴装

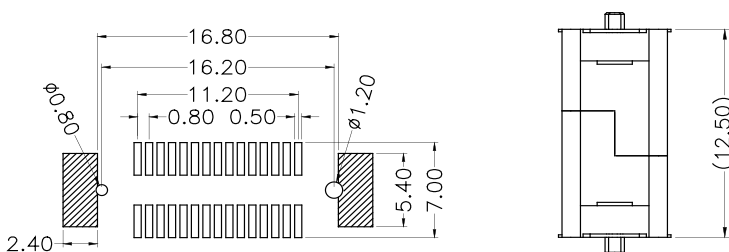

3613 Series

Dimensions 尺寸

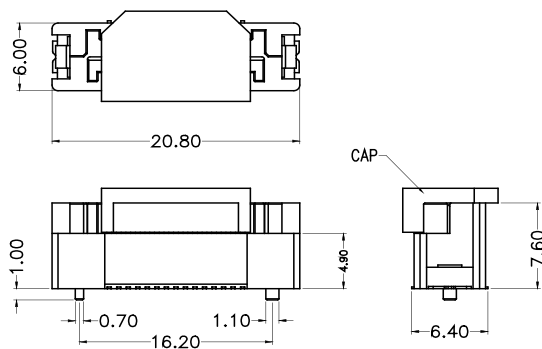

Order Information 订购信息

Circuit 芯数	Part number 型号	Plating 电镀	Remake 可量产状态
30	3613-A030-076S0R01	Gold Flash/Tin	*
	3613-A030-076S3R01	10u"Gold/Tin	
	3613-A030-076S4R01	15u"Gold/Tin	
	3613-A030-076S5R01	30u"Gold/Tin	

Note: * stands for mass production . 注: *代表可量产

Model Numbering 型号命名

3613	-	A	030	-	076	XX	R	01
(1)		(2)	(3)		(4)	(5)	(6)	(7)

(1) Series (系列): 0.80mm BTB Series

(2) Product type (产品类型): A=Hermaphrodite

(3) Positions (位数): 030=30P

(4) Housing High(塑胶高度): 076=7.60mm

(5) Plating(电镀): S0=Gold Flash/Tin、S3=10u"Gold、S4=15u"Gold、S5=30u"Gold

(6) Packing(包装): R=Reel&Reel

(7) Running Number(流水码)

Contact Us 联系我们

维峰电子股份有限公司(总部)
WCON ELECTRONICS CO.,LTD(HQ)
地址:广东省东莞市虎门镇大宁文明路15号
Add :No.15,Wenming Road,Danling Community, Humen Town, Dongguan, Guangdong.523930, China

昆山维康电子有限公司
KUNSHAN WCON ELECTRONICS CO.,LTD(East of China)
地址:昆山市千灯镇汶浦中路169号
Add : No.169, WenPu Middle Road, QianDeng Town, Kunshan City, Jiangsu Province, China

合肥维峰电子有限公司
HEFEI WCON ELECTRONICS CO.,LTD
地址:安徽合肥市高新技术开发区绿城科技园E栋2楼
Add : 2F, Building E, Greentown Science Park,High-tech Development Zone, Hefei, Anhui,China

维康电子(泰国)有限公司
WCON ELECTRONICS (Thailand) CO.,LTD
地址:泰国巴真武里府西玛铺县华瓦区洛加纳工业园
Add: VG3C+H57, Hua Wa, Si Maha Phot District, Prachin Buri 25140, Thailand

销售联系方式 Contacts Information

国际客户部 International sales department
salesdg01@wcon.com
salesdg05@wcon.com

大客户专线 Major customer dedicated department
华南: salesdg28@wcon.com
华东: salesks@wcon.com

中小客户专线 Public Customer hot line
华南: salesdg10@wcon.com
华东: salesks01@wcon.com

网络销售 Online sales department
salesdg26@wcon.com



Official Website



Product e-catalog



WeChat Public#



TikTok Public#