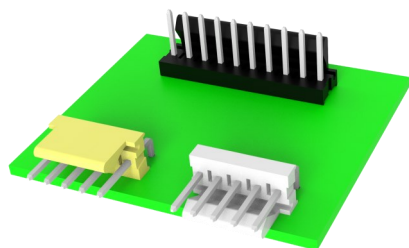

WF2544 Series

2.54mm pitch/Wire-to-board Connector

**Overview**

WF2544 supports traditional soldering processes and provides 3A current and 250V voltage for each circuit with a 2.54mm pitch. It is equipped with polarized friction lock connectors to prevent incorrect insertion and offers both vertical and horizontal connection options.

Features and Benefits

- Polarized friction lock joint
- Vertical and horizontal connections available
- Small size, high performance

Product Applications

- Medical care: diagnostic equipment, monitor (device)
- Data/Network: scanner, printer
- Home appliances: dishwasher, freezer, refrigerator

Standard 标准

- EIA-364

Material 材料

Part/零件	Material/材料	Finish/电镀	UL Flame retardant/阻燃等级
Housing/主体	/	/	/
Header/板端	PA66	Black/黑色 Beige/米色 Natural/自然色 White/白色	UL94V-0
Terminal/端子	/	/	/

WF2544系列

2.54mm间距/线到板连接器

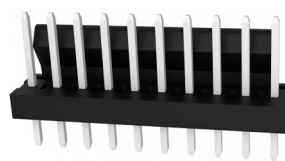
**概述**

WF2544支持传统焊接工艺，并为2.54mm间距每个电路提供3A的电流与250V的电压，同时搭配极化摩擦锁接头，防止错误对插，同时拥有垂直、水平连接方式。

产品特点

- 极化摩擦锁接头
- 提供垂直、水平连接
- 小体积，高性能

应用领域

- 医疗：诊断设备，监护仪
- 数据/网络：扫描仪，打印机
- 家电：洗碗机，冰柜，冰箱

UL certification UL认证

- E248993

Production Specifications 产品规格

Current rating 额定电流	3.0 A	Operating temperature Range:-40° C~+105° C (including temperature rise) Operating Humidity Range:20-80% 工作温度范围: -40° C~+105° C(含温升) 工作湿度范围: 20-80%	Storage temperature: Operating Humidity: 储存温度: 25±5° C 储存湿度: ≤60%
Voltage rating 额定电压	250V/AC		

Item 项目	Condition 条件	Specification 规格
Insulation Resistance 绝缘电阻	Measured at 500V DC for 1 minute 测试电压: 500V DC/1分钟	No less than 1000MΩ 不少于1000MΩ
Withstanding voltage 耐电压	Measured at 1000V AC for 1 minute 测试电压: 1000V AC/1分钟	No breakdown, no discharge, leakage current <0.5mA 无击穿、无放电、漏电流<0.5mA
Contact Resistance 接触电阻	Measured at 100mA and no higher than 20mV 用20 mV DC进行测量	Contact resistance: Initial value/ 20 mΩ max After environmental tests/ 30 mΩ max. 接触电阻: 初始值 20 mΩ 以下 测试后 30 mΩ 以下
Vibration Resistance 抗振动	Frequency : 50-2000 Hz PSD value : 5.35 G _{rms} Duration : 15 minutes /axis Vibration : X、Y、Z 频率: 50-2000 Hz PSD: 5.35 G _{rms} 时长: 15分钟/轴 振动方向: X、Y、Z	No electrical discontinuity of 1μs or greater 试验过程中未发生1μs瞬断现象, 且外观无损伤, 电气性能正常
Humidity (Steady state) 湿度	Temperature : -25° C~65° C Humidity: 90 ~95% (R.H) Duration : 96 hours 温度: -25° C~65° C 湿度: 90~95% (R.H) 时间: 96小时	Contact resistance: Initial value/ 20 mΩ max After environmental tests/ 30 mΩ max. 接触电阻: 初始值 20 mΩ 以下 测试后 30 mΩ 以下
Salt Spry 盐雾	Temperature:35± 2°C Solution concentration : 5%NaCl PHValue : 6.5 ~ 7.2 Duration : 12hours 温度: 35±2° C 溶液浓度: 5%NaCl PH值: 6.5~7.2 时间: 12小时	Contact resistance: Initial value/ 20 mΩ max After environmental tests/ 30 mΩ max. 接触电阻: 初始值 20 mΩ 以下 测试后 30 mΩ 以下
Durability(Mating/un- mating) 插拔寿命	500 cycles 循环500次	Contact resistance: Initial value/ 20 mΩ max After environmental tests/ 30 mΩ max. 接触电阻: 初始值 20 mΩ 以下 测试后 30 mΩ 以下

PCB Layout 印刷电路板布局

(S/T)DIP type 通孔焊接型

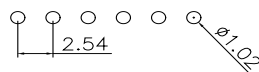

(R/A)DIP type 通孔焊接型

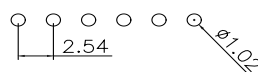

WF2544 Series

Ordering Information 订购信息

Circuit 芯数	Part number 型号		Dimensions 尺寸 (mm)		Package 包装 Qty/Bag 只/袋装		Remake 可量产状态	
	S/T DIP	R/A DIP	C	D	S/T DIP	R/A DIP	S/T DIP	R/A DIP
2	WF2544-WS02XXXXX1	WF2544-WR02XXXXXX	2.54	5.08	500	1000	*	*
3	WF2544-WS03XXXXX1	WF2544-WR03XXXXXX	5.08	7.62	1000	800	*	*
4	WF2544-WS04XXXXX1	WF2544-WR04XXXXXX	7.62	10.16	1000	500	*	*
5	WF2544-WS05XXXXX1	WF2544-WR05XXXXXX	10.16	12.70	1000	300	*	*
6	WF2544-WS06XXXXX1	WF2544-WR06XXXXXX	12.70	15.24	500	300	*	*
7	WF2544-WS07XXXXX1	WF2544-WR07XXXXXX	15.24	17.78	500	300	*	*
8	WF2544-WS08XXXXX1	WF2544-WR08XXXXXX	17.78	20.32	500	300	*	*
9	WF2544-WS09XXXXX1	WF2544-WR09XXXXXX	20.32	22.86	400	200	*	*
10	WF2544-WS10XXXXX1	WF2544-WR10XXXXXX	22.86	25.40	400	200	*	*
11	WF2544-WS11XXXXX1	WF2544-WR11XXXXXX	25.40	27.94	300	200	*	*
12	WF2544-WS12XXXXX1	WF2544-WR12XXXXXX	27.94	30.48	300	200	*	*
13	WF2544-WS13XXXXX1	WF2544-WR13XXXXXX	30.48	33.02	300	100	*	*
14	WF2544-WS14XXXXX1	WF2544-WR14XXXXXX	33.02	35.56	300	100	*	*
15	WF2544-WS15XXXXX1	WF2544-WR15XXXXXX	35.56	38.10	200	100	*	*
16	WF2544-WS16XXXXX1	WF2544-WR16XXXXXX	38.10	40.64	200	100	*	*
17	WF2544-WS17XXXXX1	WF2544-WR17XXXXXX	40.64	43.18	200	100	*	*
18	WF2544-WS18XXXXX1	WF2544-WR18XXXXXX	43.18	45.72	200	100	*	*
19	WF2544-WS19XXXXX1	WF2544-WR19XXXXXX	45.72	48.26	200	100	*	*
20	WF2544-WS20XXXXX1	WF2544-WR20XXXXXX	48.26	50.80	200	100	*	*
21	WF2544-WS21XXXXX1	WF2544-WR21XXXXXX	50.80	53.34	100	100	*	*
22	WF2544-WS22XXXXX1	WF2544-WR22XXXXXX	53.34	55.88	100	100	*	*
23	WF2544-WS23XXXXX1	WF2544-WR23XXXXXX	55.88	58.42	100	100	*	*
24	WF2544-WS24XXXXX1	WF2544-WR24XXXXXX	58.42	60.96	100	100	*	*
25	WF2544-WS25XXXXX1	WF2544-WR25XXXXXX	60.96	63.50	100	50	*	*
26	WF2544-WS26XXXXX1	WF2544-WR26XXXXXX	63.50	66.04	100	50	*	*
27	WF2544-WS27XXXXX1	WF2544-WR27XXXXXX	66.04	68.58	100	50	*	*
28	WF2544-WS28XXXXX1	WF2544-WR28XXXXXX	68.58	71.12	100	50	*	*

Note: * stands for mass production . 注: *代表可量产

Dimensions 尺寸(S/T DIP)

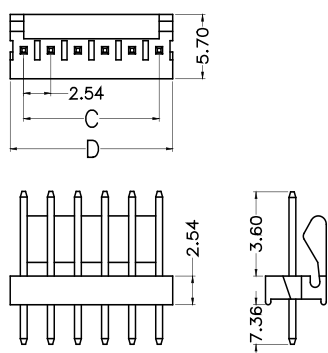

Dimensions 尺寸(R/A DIP)

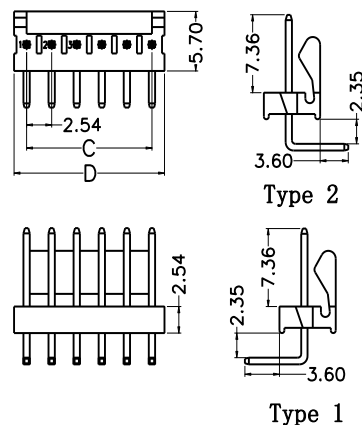

Model number allocation 型号命名

WF2544	-	XX	XX	XX	B	X	X
(1)		(2)	(3)	(5)	(6)	(7)	(8)
(1) Series (系列): Wafer 2.54mm Series				(5) Color (颜色): B=Black、E=Beige、T=Natural、W=White			
(2) Terminal type (端子形态): WS=S/T DIP、WR=R/A DIP				(6) Packing (包装): T=Tube、0=PE Bag			
(3) Circuit (位数): 2=2P.....28=28P				(7) Internal code (流水码): 1=Type 1、2=Type 2			
(4) Contact Plating (电镀): Blank=Tin、GX=xx u" Gold							

Contact Us 联系我们

维峰电子股份有限公司 (总部)
 WCON ELECTRONICS CO.,LTD(HQ)
 地址:广东省东莞市虎门镇大宁文明路15号
 Add :No.15,Wenming Road,Danling Community, Humen Town, Dongguan, Guangdong.523930, China

昆山维康电子有限公司
 KUNSHAN WCON ELECTRONICIS CO.,LTD(East of China)
 地址:江苏昆山千灯镇汶浦中路169号
 Add : No.169, WenPu Middle Road, QianDeng Town, Kunshan City, Jiangsu Province, China

合肥维峰电子有限公司
 HEFEI WCON ELECTRONICIS CO.,LTD
 地址:安徽合肥市高新技术开发区绿城科技园E栋2楼
 Add : 2F, Building E, Greentown Science Park,High-tech Development Zone, Hefei, Anhui,China

维康电子(泰国)有限公司
 WCON ELECTRONICS (Thailand) CO.,LTD
 地址:泰国巴真武里府西玛铺县华瓦区洛加纳工业园
 Add: VG3C+H57, Hua Wa, Si Maha Phot District, Prachin Buri 25140, Thailand

销售联系方式 Contacts Information

国际客户部 International sales department
 salesdg01@wcon.com
 salesdg05@wcon.com

大客户专线 Major customer dedicated department
 华南: salesdg28@wcon.com
 华东: salesks@wcon.com

中小客户专线 Public Customer hot line
 华南: salesdg10@wcon.com
 华东: salesks01@wcon.com

网络销售 Online sales department
 salesdg26@wcon.com



Official Website



Product e-catalog



WeChat Public#



TikTok Public#