

WF2541 Series WF2541系列

2.54mm pitch/Wire-to-board Connector 2.54mm间距/线到板连接器

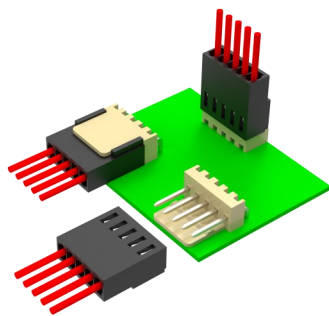

Single-point contact
单点接触

Overview

Ideal for industries such as automotive, industrial, medical and consumer, the Signal Applications WF2541 connector delivers up to 3A per circuit and 250V per circuit in a 2.54mm centreline pitch with 22 to 28 AWG wire.

概述

信号应用WF2541连接器是汽车、通讯、医疗和消费类等行业的理想选择，可在 2.54 毫米中心线间距中提供每电路高达3A 的电流和 250V 的电压，提供 22 至 28 AWG 的导线

Features and Benefits

- Optional high temperature resistant plastic for high temperature environments
- Dual cantilevered terminals to ensure reliable connections in low insertion conditions
- Friction locking structure to ensure secure mating and prevent dislodgement
- Dull proof structure to prevent mismatch during assembly

产品特点

- 可选耐高温塑胶，满足高温环境
- 双悬臂端子，确保在低插入条件下实现可靠连接
- 带有摩擦锁结构，确保牢固插配，防止脱落
- 带有防呆结构，防止组装过程中错配

Product Applications

- Automotive: control modules, lighting fixtures, audio, display panels
- Communications: scanners, printers, workstations
- Medical: portable diagnostics, dental equipment, monitors
- Consumer: home appliances, residential security, HVAC

应用领域

- 汽车：控制模块、照明器具、音响、显示面板
- 通讯：扫描仪、打印机、工作站
- 医疗：便携式诊断器、牙科设备、监测仪
- 消费：家用电器、住宅安防、HVAC

Standard 标准

- EIA 364

UL certification UL认证

- E248993

Material 材料

Part/零件	Material/材料	Finish/电镀	UL Flame retardant/阻燃等级
Housing/主体	PA66	Beige/米色	UL94V-0
Header/板端	PA66/PA46/LCP	Natural/本色 Beige/米色 Black/黑色	UL94V-0
Terminal/端子	phosphor bronze/Brass (C5191)	Au or Sn plated 镀金或锡	-

Production Specifications 产品规格

Current rating 额定电流	3.0 A	Operating Temperature Range:-40° C~+105° (including temperature rise) Operating Humidity Range:20-80% 工作温度范围: -40° C~+105° C(含温升) 工作湿度范围: ≤80%	Storage Teroerature: Operating Humidity: 储存温度: 25±5° C 储存湿度: ≤60%
Voltage rating 额定电压	250V		

Item 项目	Condition 条件	Specification 规格
Insulation Resistance 绝缘电阻	Measured at 1000V DC for 1 minute 测试电压: 1000V DC/1分钟	No less than 1000M Ω 不少于1000MΩ
Withstanding voltage 耐电压	Measured at 1000V AC for 1 minute 测试电压: 1000V AC/1分钟	No breakdown, no discharge, leakage current <0.5mA 无击穿、无放电、漏电流<0.5mA
Contact Resistance 接触电阻	Measured at 1mA and no higher than 20mV 用20 mV DC进行测量	Contact resistance: Initial value/ 20 mo max After environmental tests/ 30 mo max. 接触电阻: 初始值 20 mΩ 以下 测试后 30 mΩ 以下
Vibration Resistance 抗振动	Frequency : 50 ~ 2000 Hz PSD value : 5.35 Gms minimum Duration : 15 minutes/axis Times : Each of three mutually perpendicular planes. 频率: 50 ~ 2000 Hz PSD值: 5.35 Gms 时长: 15分钟/轴 次数: 3次	No electrical discontinuity of 1μsorgreater 试验过程中未发生1μs瞬断现象, 且外观无损伤, 电气性能正常
Humidity (Steady state) 湿度	Temperature : 25~65°C Humidity: 90 ~95% (R.H) Duration : 96 hours 温度: 25~65° C 湿度: 90 ~95% (R.H) 时间: 96小时	Contact resistance: Initial value/ 20 mo max After environmental tests/ 30 mo max. 接触电阻: 初始值 20 mΩ 以下 测试后 30 mΩ 以下
Salt Spray 盐雾	Temperature:35#2°C Humidity:95~98%(R.H) PHValue : 6.5 ~ 7.2 Duration : 12hours 温度: 35±2° C 湿度: 95~98%(R.H) PH值: 6.5~7.2 时间: 12小时	Contact resistance: Initial value/ 20 mo max After environmental tests/ 30 mo max. 接触电阻: 初始值 20 mΩ 以下 测试后 30 mΩ 以下
Durability(Mating/un-mating) 插拔寿命	500 cycles 循环500次	Contact resistance: Initial value/ 20 mo max After environmental tests/ 30 mo max. 接触电阻: 初始值 20 mΩ 以下 测试后 30 mΩ 以下

PCB Layout 印刷电路板布局

Through-hole type 通孔型

(S/T DIP、R/A DIP)

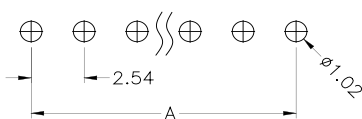

WF2541 Series

Ordering Information 订购信息

Circuit 芯数	Part number 型号		Dimensions 尺寸 (mm)		Package 包装 Q'ty/Bag 只/袋装		Remake 可量产状态	
	S/T DIP	R/A DIP	A	B	S/T DIP	R/A DIP	S/T DIP	R/A DIP
2	WF2541-WS (H) 02X01	WF2541-WR (H) 02X0X	2.54	5.08	1000	1000	*	
3	WF2541-WS (H) 03X01	WF2541-WR (H) 03X0X	5.08	7.62	1000	1000	*	
4	WF2541-WS (H) 04X01	WF2541-WR (H) 04X0X	7.62	10.16	1000	1000	*	
5	WF2541-WS (H) 05X01	WF2541-WR (H) 05X0X	10.16	12.70	1000	1000	*	*
6	WF2541-WS (H) 06X01	WF2541-WR (H) 06X0X	12.70	15.24	500	500	*	
7	WF2541-WS (H) 07X01	WF2541-WR (H) 07X0X	15.24	17.78	500	500	*	
8	WF2541-WS (H) 08X01	WF2541-WR (H) 08X0X	17.78	20.32	500	500	*	
9	WF2541-WS (H) 09X01	WF2541-WR (H) 09X0X	20.32	22.86	400	400	*	
10	WF2541-WS (H) 10X01	WF2541-WR (H) 10X0X	22.86	25.40	400	400	*	
11	WF2541-WS (H) 11X01	WF2541-WR (H) 11X0X	25.40	27.94	300	300	*	
12	WF2541-WS (H) 12X01	WF2541-WR (H) 12X0X	27.94	30.48	300	300	*	*
13	WF2541-WS (H) 13X01	WF2541-WR (H) 13X0X	30.48	33.02	300	300	*	
14	WF2541-WS (H) 14X01	WF2541-WR (H) 14X0X	33.02	35.56	300	300	*	
15	WF2541-WS (H) 15X01	WF2541-WR (H) 15X0X	35.56	38.10	200	200	*	
16	WF2541-WS (H) 16X01	WF2541-WR (H) 16X0X	38.10	40.64	200	200	*	
17	WF2541-WS (H) 17X01	WF2541-WR (H) 17X0X	40.64	43.18	200	200	*	
18	WF2541-WS (H) 18X01	WF2541-WR (H) 18X0X	43.18	45.72	200	200	*	
19	WF2541-WS (H) 19X01	WF2541-WR (H) 19X0X	45.72	48.26	200	200	*	
20	WF2541-WS (H) 20X01	WF2541-WR (H) 20X0X	48.26	50.80	200	200	*	

Note: * stands for mass production . 注: *代表可量产

Dimensions 尺寸(S/T DIP)

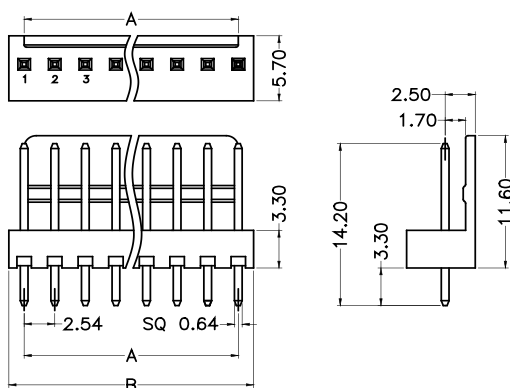

Dimensions 尺寸(R/A DIP)

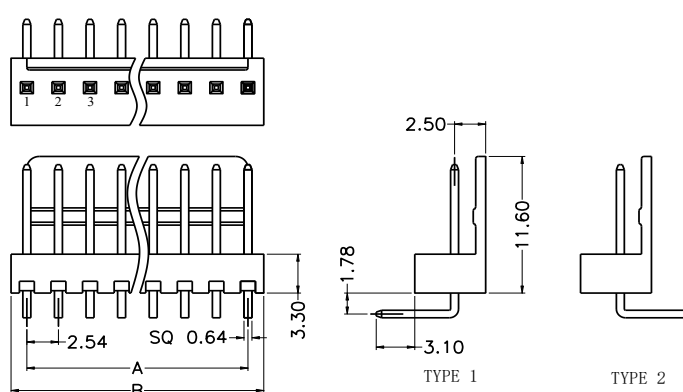

Assembly Schematic 装配示意

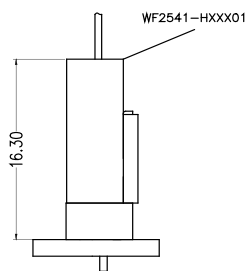

Assembly Schematic 装配示意

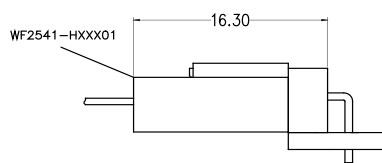

Dimensions 尺寸

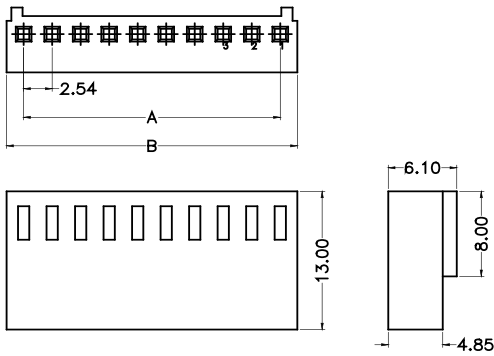

Ordering Information 订购信息

Circuit 芯数	Part number 型号	Dimensions 尺寸 (mm)		Package 包装 Qty/Bag 只/袋装	Remake 可量产状态
		A	B		
2	WF2541-H02E01	2.54	5.58	1000	*
3	WF2541-H03E01	5.08	8.12	1000	*
4	WF2541-H04E01	7.62	10.66	1000	*
5	WF2541-H05E01	10.16	13.20	1000	*
6	WF2541-H06E01	12.70	15.74	1000	*
7	WF2541-H07E01	15.24	18.28	1000	*
8	WF2541-H08E01	17.78	20.82	1000	*
9	WF2541-H09E01	20.32	23.36	1000	*
10	WF2541-H10E01	22.86	25.90	1000	*
11	WF2541-H11E01	25.40	28.44	500	*
12	WF2541-H12E01	27.94	30.98	500	*
13	WF2541-H13E01	30.48	33.52	500	*
14	WF2541-H14E01	33.02	36.06	500	*
15	WF2541-H15E01	35.56	38.60	500	*
16	WF2541-H16E01	38.10	41.14	500	*

Note: * stands for mass production . 注: *代表可量产

Adaptor Terminal 适配端子

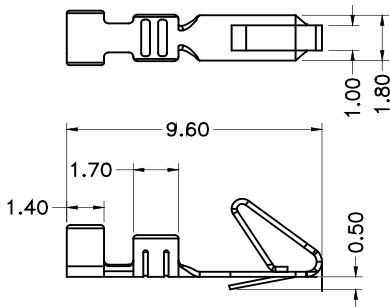

Ordering Information 订购信息

型号 Model number	材质 Material	电线规格 Wire size	绝缘外径 Insulation O.D
WF2541-TBSN01	Brass	AWG#22~#28	1.50mm(Max)
WF2541-TPSN01	Phosphor bronze	AWG#22~#28	1.50mm(Max)

Model number allocation 型号命名

WF2541	-	XX	(H)	XX	X	X	X
(1)		(2)	(3)	(4)	(5)	(6)	(7)
(1) Series (系列): Wafer 2.54mm Series					(5) Color(颜色): E=Eeige、B=Black、T=Natural		
(2) Terminal type (端子形态): WS=S/T DIP WR=R/A DIP				(6) Packing (包装): 0=PE Bag、R=Reel			
(3) material (材质): H=High temperature material 高温料 Blank=Low temperature material 低温料					(7) Internal code (流水码): 1=Type 1、2=Type 2		
(4) Circuit (位数): 02=2.....20=20P							

WF2541	-	H	XX	E	0	1
(1)		(2)	(3)	(4)	(5)	(6)
(1) Series (系列): Wafer 2.50mm Series				(4) Color(颜色): E=Eeige		
(2) Product type (产品类型): H=Crimp Type Housing				(5) Packing (包装): 0=PE Bag		
(3) Circuit (位数): 02=2.....16=16P				(6) Internal code (流水码)		

Contact Us 联系我们

维峰电子股份有限公司(总部)
WCON ELECTRONICS CO.,LTD(HQ)
地址:广东省东莞市虎门镇大宁文明路15号
Add :No.15,Wenming Road,Daning Community, Humen Town,
Dongguan, Guangdong.523930, China

昆山维康电子有限公司
KUNSHAN WCON ELECTRONICS CO.,LTD(East of China)
地址:昆山市千灯镇汶浦中路169号
Add : No.169, WenPu Middle Road, QianDeng Town, Kunshan
City, Jiangsu Province, China

合肥维峰电子有限公司
HEFEI WCON ELECTRONICS CO.,LTD
地址:安徽合肥市高新技术开发区绿城科技园E栋2楼
Add : 2F, Building E, Greentown Science Park,High-tech Development Zone, Hefei, Anhui,China

维康电子(泰国)有限公司
WCON ELECTRONICS (Thailand) CO.,LTD
地址:泰国巴真武里府西玛铺县华瓦区洛加纳工业园
Add: VG3C+H57, Hua Wa, Si Maha Phot District, Prachin Buri
25140, Thailand

销售联系方式 Sales Contacts

国际客户部 International Sales Department
salesdg01@wcon.com
salesdg05@wcon.com

大客户专线 Key Account Line
华南: salesdg28@wcon.com
华东: salesks@wcon.com

中小客户专线 Small and Medium-sized Account Line
华南: salesdg10@wcon.com
华东: salesks01@wcon.com

网络销售 Online sales
salesdg26@wcon.com



Official Website



Product e-catalog



WeChat Public#



TikTok Public#